

DH1114101

UNDER CONSTRUCTION / EN CONSTRUCCIÓN



## Villa in Calpe

€847,000

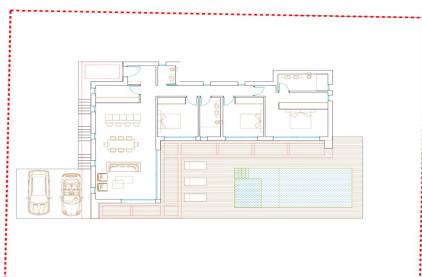

3



3



176m<sup>2</sup>



1,000m<sup>2</sup>



This beautiful development is located in the Empedrola II area, a quiet urbanisation perfectly connected to the centre of Calpe, which is just a 10-minute drive away. With a perfect south-facing orientation and stunning views of the impressive Peñon de Ifach, this property will offer a place of tranquillity and relaxation. This fantastic villa is designed over a single storey and offers three bedrooms with suite-sized double beds, a spacious and bright living-dining room connected to a modern open-plan kitchen, from where large windows give access to the garden where you can enjoy the pool, two beautiful verandas and stunning views of the Rock of Calpe. The villa is currently (Ask for More Details!)